



pmsfTM
Family
CONFERENCE

Know Before You Go

neuren
pharmaceuticals
**PRESENTING
SPONSOR**

Packing List

For a full list of activities to do in and around Bloomington, [click here](#).

Activities: Puzzles, coloring books and crayons, games, etc. are key to any good trip! Don't underestimate the versatility of a deck of cards.

Airplane Travel Harness: Cares Airplane Safety Travel Harness can be found on Amazon [here](#).

Communication Aids: Be sure to pack any and all communication aids including picture boards, tablets, and sign language materials.

Daily Personal Care: In addition to shampoo and toothpaste, be sure to bring any specialized personal care items like diapers, incontinence supplies, and specific skin care products.

Emergency Contacts: Bring a list of emergency contacts such as healthcare providers and family members for quick access. Consider bringing an I.D. bracelet or other identifier for your individual with Phelan-McDermid that has your contact info on it.

Genetic Report: Bring a copy either digitally or physically of your individual with Phelan-McDermid's genetic report so you can follow along during our Immersive Genetics 101 session.

Laundry: Tidy up with personal laundry service tools like the [Scrubba Portable Washing Machine](#). Then hang your clothes out to dry on a retractable, portable [clothes hanging line](#).

Medical: Be sure to bring extra medications if possible, particularly for seizures. Bring a copy of your loved one's medical records. The nearest emergency room is located at M Health Fairview Southdale Hospital, 6401 France Ave. S., Edina, MN 55435 with a 24 hour ER (952) 924-5000. The nearest [walk-in clinic](#) is located inside the Mall of America on the 3rd level. Open from 11 AM - 7 PM at 332 E. Broadway, Suite 332.

Packing List (Cont')

For a full list of activities to do in and around Bloomington, [click here](#).

Mobility: Pack your wheelchair, walker, or any other mobility aids to easily get around the conference. Bring along any needed physical therapy items to ensure mobility across every day.

Painter's Tape: Bring along some painter's tape to cover any unused outlets in your hotel room! Painter's tape will ensure you don't damage the hotel's walls. You can find some on Amazon [here](#).

Peapod Travel Tent: Pop up a portable tent for your child with KidCo's Peapod Travel Bed, which can be purchased [here](#).

Portable Purée Machine: Bring your favorite brand of portable purée machine to be able to mince up food for your individual with Phelan-McDermid or any little ones you may have with you. Battery powered or rechargeable would be ideal. Example: [Magic Bullet](#)

Schedule: Study the [agenda](#) ahead of time so you can plan out needed breaks and get the most out of your conference experience.

Sensory Comfort: A favorite toy, a sensory object, headphones, a stuffed animal, or whatever calms your loved one with Phelan-McDermid, don't forget to pack it!

Summer Camp Clothes: You read right! Our Dance Party this year is Summer Camp themed! Pack your best shorts and sneakers and get ready to eat some s'mores.

Sweaters & Jacket: Though the weather outside is bright and sunny, be prepared for chilly session rooms! You don't want your teeth chattering to cover the sound of our brilliant speakers.

TSA Cares: If you are flying, remember to contact [TSA Cares](#). Every airport is a little different so reach out soon. This can make a big difference in your travel experience.

Hotel Information

Radisson Blu Mall of America
2100 Killebrew Drive
Bloomington, MN 55425

Phone: (952) 314-5116

Wifi: RadissonBlu
No password needed

Hours of Operation:

Room Service = 6:30 AM - 11:00 PM

Café Blu Grab 'n Go Breakfast = 6:00 AM - 9:00 AM

FireLake Grill & Bar Restaurant = 6:30 AM - 2:00 PM & 5:00 PM - 10:00 PM

Airport Shuttle:

Daily 5 AM - 11 PM

Departs every 30 minutes

Complimentary shuttle to and from MSP International Airport. At the airport, look for the Radisson Blu shuttle in the hotel shuttle area. If you do not see it, call (952) 881-5258 to request service. Call (952) 260-8425 for a wheelchair-accessible shuttle.

Parking:

Mall of America parking is free. When you get to the hotel, however, you must notify the front desk that you parked in MOA and provide your vehicle information to them.

To park at the hotel, you can self-park for \$24/day. You can park valet for the day for \$19 or valet overnight for \$34/night.

Weather:

Expect sunny days and a low chance of rain! Average high of 85 degrees Fahrenheit, average low of 67 degrees Fahrenheit with a 15% average chance of precipitation.

Mall of America Information

Getting Around the Mall

Info kiosks are located throughout the mall. A map and directory are also [available online](#) at the MOA website.

Restaurants

[Lunch Options](#): Visit this link to see a list of restaurants with Order Ahead capability to save time during your busy conference schedule.

The FireLake Grill & Bar now has a Grab 'n Go option for breakfast! Check out the menu for Café Blu [here](#).

To see a list of full-service restaurants, [click here](#).

Accessibility

Strollers, wheelchairs, and shopping carts are available for rent at all Guest Service desks.

Restrooms

All restrooms have wheelchair-accessible stalls.

Companion (family) restrooms are located on Level 1 at the North, South, East, and West entrances. Also at the Level 2 & 3 North restrooms. (See Map below)

A restroom equipped with an adult changing table is available in the southwest corner of Nickelodeon Universe on Level 1, near FlyOver America.

Service Animal Relief Areas

MOA offers two outdoor service animal relief areas. Both areas are marked by pet waste clean-up stations.

Exit Level 1 East doors and head north (or turn left as you exit MOA), walking along the sidewalk toward Lindau Lane.

Exit Level 1 South doors and cross the street. Turn right and walk around Radisson Blu. It is located on the west side of Radisson Blu.

Quiet Space

At the conference: There will be a “Sensory Room” set up in the Harriet room at the conference. It will be open during sessions and evening events. You must have signed the waiver in registration to use it and you use at your own risk. This is a self-supervised area. Come by to chill out!

In the Mall: Nickelodeon Universe offers a designated quiet space for guests with sensory issues. The area is located behind Guest Services, near the exit of Pepsi Orange Steak.

Quiet room features include:

- Dimmable lights
- Soft seating
- Interactive wall displays
- Soundproof walls
- Air conditioning
- Headphones are available

In order to provide this service to all who may need it, Nickelodeon Universe asks that only one family use the space at a time and that guests limit their visit to 30 minutes or less. Food and beverages are not permitted.

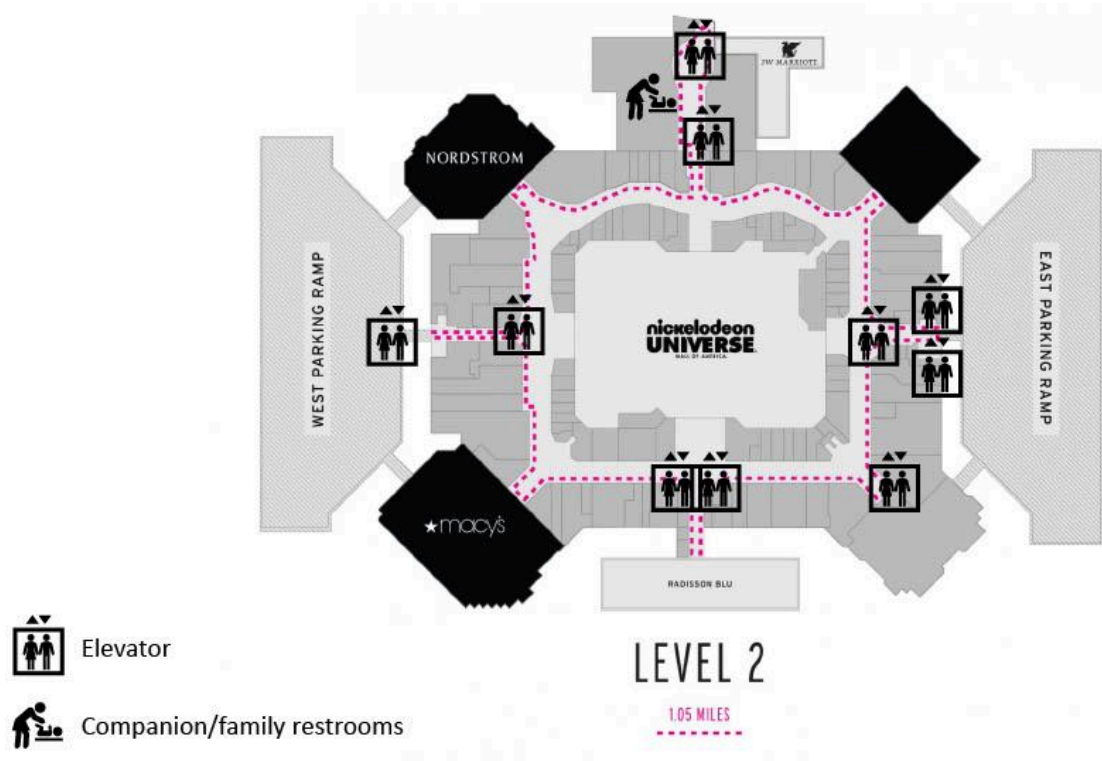
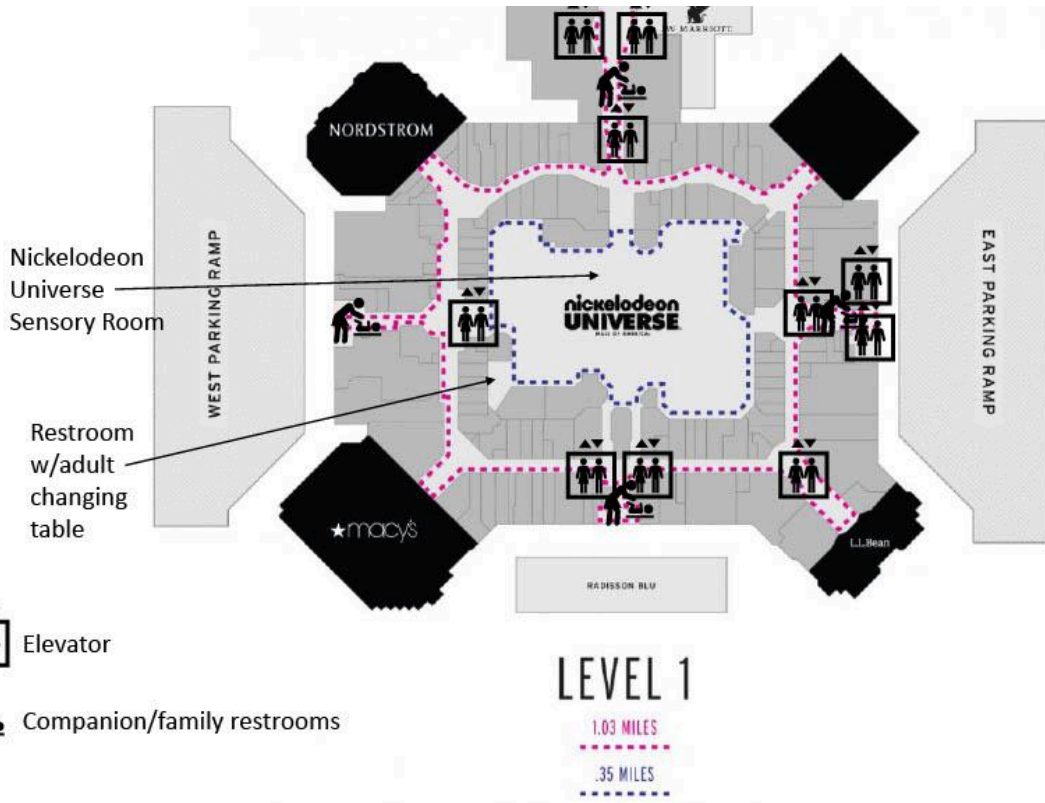

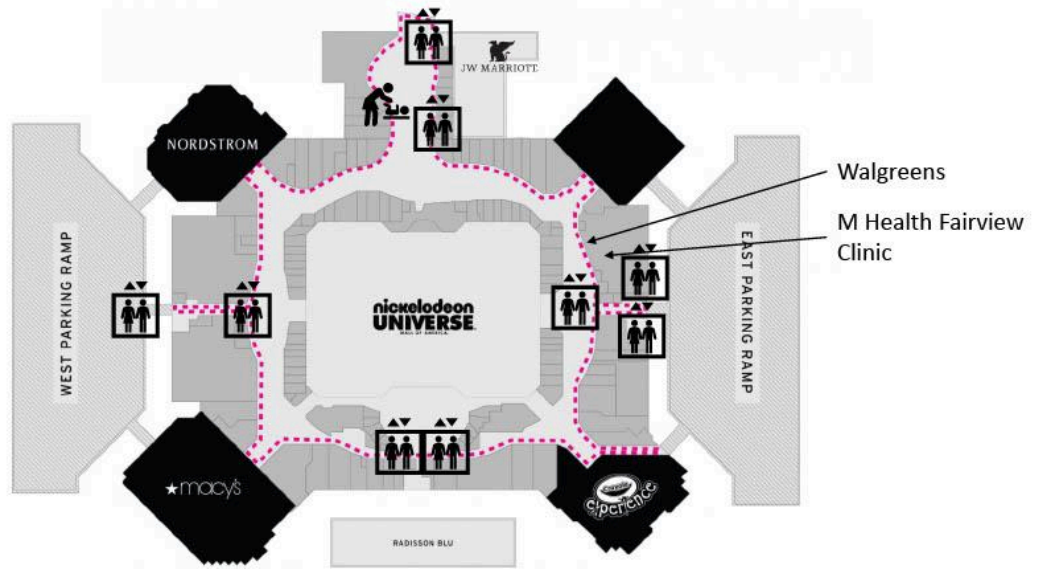

LEVEL 3

1.04 MILES

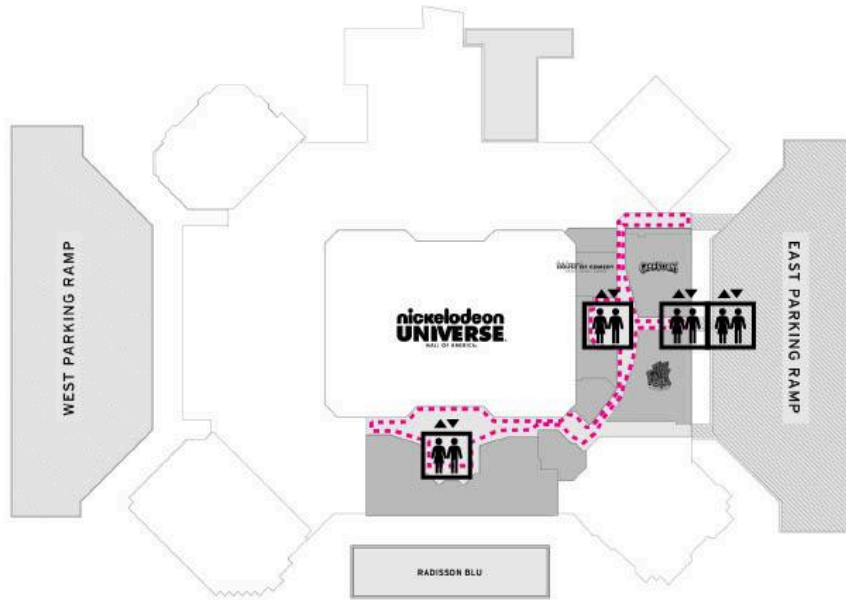

LEVEL 4

.64 MILES



THANK YOU FOR CHOOSING TO STAY WITH US!

Our primary concern is the health and safety of our guests and associates. We are committed to welcoming our guests while facilitating open communication and supporting the needs of our visitors. Below you will find important information pertaining to your stay.

Housekeeping Services

We offer daily housekeeping services throughout your stay
Please Dial '0' for any other housekeeping requests

Blu Planet

Please inform our agents at check in if you choose not to receive daily housekeeping services during your stay. This will earn your Choice Privileges account 500 points per night. Housekeeping will enter your room on the 3rd night in accordance with state laws.



FireLake Grill House & Cocktail Bar

Located on the 2nd Floor of the Hotel.
Reservations are Strongly Encouraged.
For Menu and Hours, Scan QR Code:



Room Service

Available Daily 6:30a.m. – 11p.m.

Menu can be Found on Your Guestroom TV

Menu > Hotel Info > Dining

Or See FireLake Menu QR Code Above:

Café Blu

Grab-N-Go breakfast is available daily from 6am-9am in FireLake Grill House & Cocktail Bar.

Swimming Pool & Fitness Center

Located on the 3rd Floor of Hotel
Guest Room Key Required for Access
Pool Hours: 5a.m. – 11p.m.
Fitness Center Hours: 24 Hours!

Snack, Drink and Toiletry Vending

Floors 3, 5 & 10 for Snack Vending
Floors 3-12 for Drink Vending
Floor 3 for CVS Vending Machine with Toiletries & Medicine
Floor 3 for Microwaves Adjacent to Vending Machines
All Floors have Ice Machines Adjacent to Elevators

Airport Shuttle

Daily 4a.m. to 11p.m. Departing on the Hour & Half Hour
Visit the Front Desk to Reserve a Spot on an Outgoing

Shuttle for Departure

Choice Privileges

Start earning points today!

Scan the QR code,
visit the Front Desk or
Dial '0' on Your Guest Room Phone.



Pets

We are a Pet-Friendly Hotel

\$100 Non-Refundable Pet Fee Applies

(No Fee for Verified Service Animals)

Dogs Allowed up to 50 lbs., Maximum of 2 Dogs per Room

Pets (except Service Animals) Not Allowed in the Pool Area

(Fees Apply Should Pets be Found in the Pool Area)

Pets Must be Leashed in Public Areas

Dogs Cannot be Left Alone in Guest Rooms

(Noise Complaints Result in Fees or Eviction)

Parking

Self-Parking at the Hotel Ramp \$24 per Night

Valet Parking is \$34 per Night

Safety & Security

Hotel Front Doors on the Main Lobby Level Lock Nightly

11p.m. – 8a.m. Nightly

Access is Only Possible with Your Guest Room Key

Guest Room Floor Stairways are **Emergency Use Only**

Stairway Doors will Lock Behind You

Exit Only at the Ground Level

Dining, Shopping and Entertainment!

Skyway to Mall of America Located on 2nd Level of Hotel

See QR Codes Below for Hours, Tickets and More:



Thank you for choosing to stay with us,

Alberto J. Abreu,

General Manager

Alberto.Abreu@RadissonBluAmericas.com